

HOMEFONT FARMERS

YARD TO TABLE



Design & Build Construction	Garden Maintenance
--------------------------------	-----------------------

(203) 938-0900

info@homefrontfarmers.com

Redding, CT

www.homefrontfarmers.com

ALL ABOUT HOMEFRONT

We're a family-owned business focused on giving you the tools & services needed to produce your own food at home organically. Our home base is in Redding, Connecticut where we grow unique heirloom vegetables, fruit, herbs, and flowers, in our certified organic greenhouse all season long.

So why do we do what we do? Something about growing food simplifies life. It feels nurturing and wholesome in a time when kids are growing up too fast. It's a moment of zen in your day that doesn't involve a screen. It's knowing you're feeding your family pure organic goodness in an era of green-washed marketing. It's feeling good about your environmental impact as a steward of this beautiful planet.



2024

OUR TEAM

Homefront Farmers

We are kind, authentic people united by a love of nature and healthy living. We believe that everyone has the ability to contribute to the health of the planet and their families through yard-to-table organic food. We are experts in sustainable horticulture and are committed to sharing that knowledge with everyone we meet!



homefrontfarmers.com/who-we-are/



WHAT WE DO

CONSTRUCTION

Our gardens are works of art that blend seamlessly into your landscape. Built out of white cedar, red cedar, or stone, our signature keyhole design maximizes space and efficiency to ensure all parts of the garden are reachable and usable. Our enclosures discourage deer, rabbits and burrowing animals from entering, and encourage beneficial pollinators with our exterior window boxes.



MAINTENANCE

Our seasonal maintenance service helps you bypass beginner mistakes & ensures your garden is successful & productive from year one. Our expert farmers visit weekly to plant, prune, weed, thin, trellis, fertilize, & practice organic pest management.

OUR SIGNATURE KEYHOLE DESIGN

8' X 16'

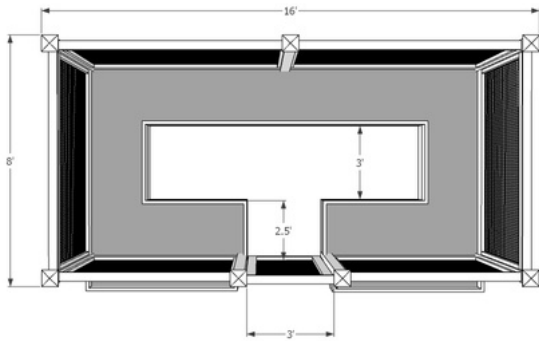

A small garden (100 sq. ft) for those looking to incorporate some home-grown produce into their meals, the perfect size for a salad garden and herbs. For a garden this size, we do not recommend growing watermelon, sweet potatoes, winter squash or strawberries.

\$11,995

16' X 24'

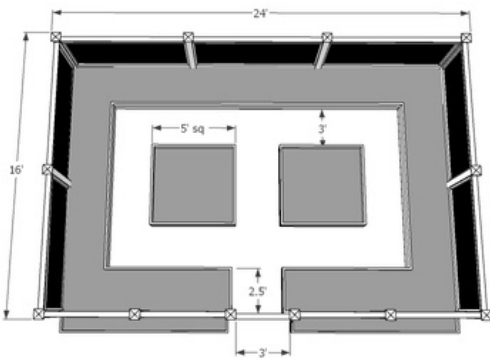

A medium sized garden (240 sq. ft) for those looking to grow a larger quantity and wider variety of vegetables, herbs, fruit. and flowers. Includes two standalone 5'x5' island beds perfect for perennials like strawberries and asparagus.

\$19,995

16' X 32'

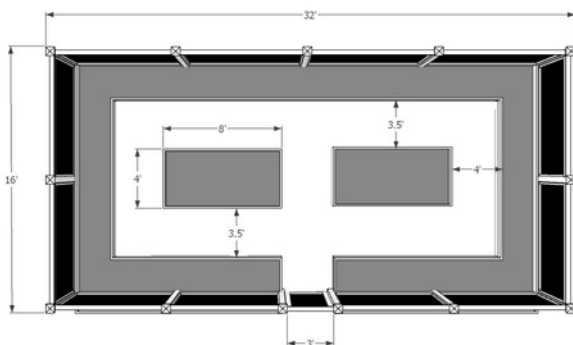

A large garden (300 sq. ft) perfect for bigger families or anyone who wants significant crop variation and substantial food & flower harvests. Includes two 4'x8' island beds and the sky is the limit on what you can grow through Spring, Summer, and Fall!

\$23,995

Prices listed for white cedar and assume level, accessible location. Site leveling not included.

THE PROCESS

Homefront Farmers

Our construction process has been fine-tuned over the past decade to ensure each step goes smoothly as we design and build your dream garden.

STEP ONE: SITE VISIT	STEP TWO: PROPOSAL
We meet you at your property to discuss size, shape, sunlight, slope, and irrigation needs.	Based off the intel gleaned at your site visit, we create your custom proposal for you to review, share feedback, and edit.
STEP THREE: CONTRACT	STEP FOUR: CONSTRUCTION
Once the proposal is finalized, we generate your contract. Upon signature and 50% deposit you'll be added to our build queue which is first come, first served.	You'll meet us the morning we start construction as we stake out the garden to confirm placement and layout is correct. Garden construction generally takes between three days and a week, weather dependent.
STEP FIVE: SOIL & GRAVEL	STEP SIX: IRRIGATION
Once construction is complete, soil & gravel will be delivered and placed onto tarps. Our crew will install hardware cloth and weedblock fabric and fill in the soil & gravel.	While we do not install irrigation, we're happy to manage the relationship with your current provider or recommend a provider so that drip irrigation can be placed in garden beds.

GARDEN MAINTENANCE



Our garden maintenance service is the perfect solution for busy families or garden novices! Homesteading is our passion and we are certified organic through both Bay State & NOFA. Our expert farmers take loving care of your garden weekly from April to November. Following each visit, you'll receive a summary email detailing planting and seeding, harvesting information, organic solutions used, and some of our favorite recipes for the harvest that week.

Our Garden Blueprint is a 1x1 virtual consultation with our Master Gardener which culminates in a three-seasons growing guide for your garden. This service is also available to those who maintain their own gardens, but want to lean on our expertise to bypass crop rotation, shading, companion, and succession planting errors.

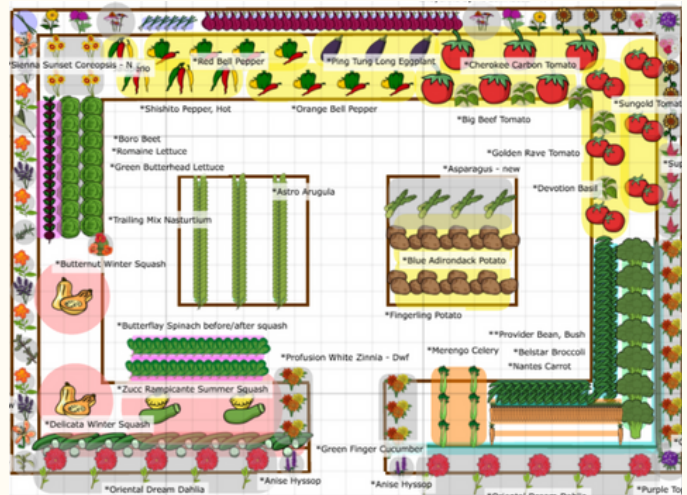

HOMESTEAD SERVICES

There are so many different facets of homesteading and learning how to live gently on the land while becoming more self-sufficient. Our homestead services help you get the most out of your property, mindfully and organically. If you're interested in beekeeping, berries, composting & other wood structures, let us know! Our experts are ready to teach you.



Bi-Weekly
Beekeeping



Berry
Planting & Maintenance



Backyard
Composting



Berry Enclosures, Chicken Runs, and
Wood Structures

HOMEFONT FARMERS

A RIVERSIDE FENCE
COMPANY



(203) 938-0900

info@homefrontfarmers.com

Redding, CT

www.homefrontfarmers.com

